

XY-Stage 5102.07

- compact linear stage for the positioning of light samples or mountings
- equipped with Faulhaber or Oriental step motor, flange size 20mm
- multi-axis positioning systems possible by simple combination of stages
- wear resistant delta bronze spindle nut
- smoothed and tempered thread spindle (self-locking)
- robust surfaces through galvanic natural-anodising treatment

Modularly individually configurable:

- from basic model to high-end system
- to multi-axis systems
- with customer-specific hole pattern

Application specific versions:

- vacuum suitable
- antimagnetic
- radiation resistant
- in black

Maximum load:

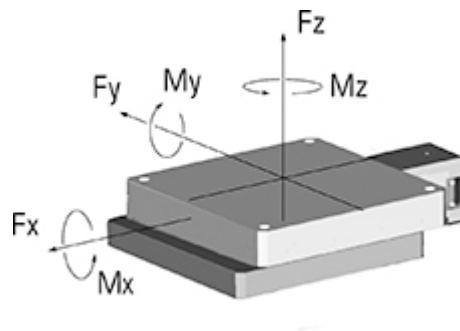

A general statement of maximum load and torque capacities is not possible for eccentric forces due to the amount of different configurations.

However, our engineers will gladly calculate the maximum load capacity for your specific application.

Accessories:

Motors:

2-/5-Ph. included

Limit switches:	included
Zero-point control:	9100
Encoder:	incremental absolute
Control system:	9300

Dimensions [mm]:

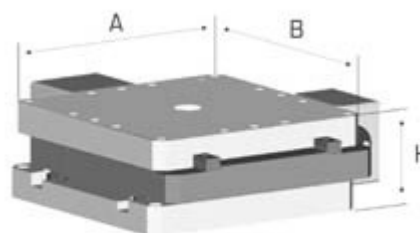

A:	B:	H:
58	58	32

Specifications:

Travel range [mm]:	+/- 6
Material (base/slide):	Aluminium
Spindle pitch [mm]:	0.5
Max. load [N]:	55
Min. drive torque [Nm]:	0.02
Stiffness ["/Nm]:	55
Weight [kg]:	0.7

Precision configurations:

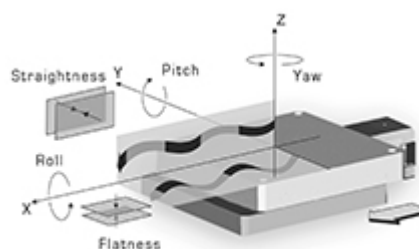

		X1
Accuracy [μm]:	(+/-)	6
Repeatability (unidir.) [μm]:	(+/-)	1
Reversal error [μm]:		1
Flatness [μm]:	(+/-)	4
Straightness [μm]:	(+/-)	4
Wobble ["]:	(+/-)	3
Pitch ["]:	(+/-)	3
Roll ["]:	(+/-)	3

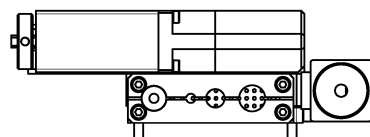
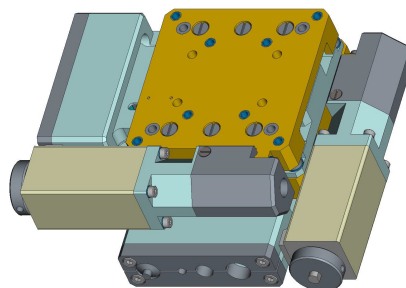
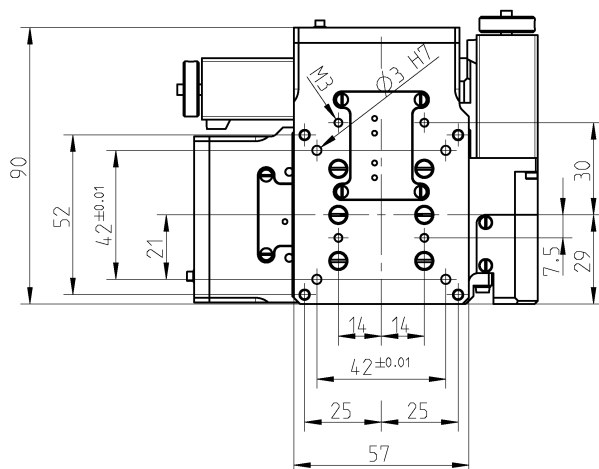

Translation $\pm 6 \text{ mm}$

