



## Gear Boxes Series 2000

The series 2000 gear boxes were developed in order to increase the resolution of our positioning systems.

The gear boxes are available for three flange sizes (42/56/83mm).

For worm gear drive systems the drive shaft is at right angles to the motor shaft. The output drive shaft position is either on the left or the right hand side of the gear box (versions 'L' and 'R'). For the version 'L' gear boxes the input rotation direction remains the same, for version 'R' gear boxes it is reversed.

- suitable for high revolutions and torque
- high-quality materials
- basically maintenance-free
- low freedom of play
- further versions: vacuum suitable, antimagnetic, radiation resistant, in black

### Flange size 42mm

	2042.10	2042.20
Ratio:	10:1	20:1
Reversal error [min]:	1.5	1.0
Efficiency:	0.60	0.35
Min. drive torque [Nm]:	0.06	0.06
Max. output torque [Nm]:	0.75	0.75
Max. revolutions [rev/s]*:	35	35
Weight [kg]:	0.3	0.3

### Flange size 56mm

	2056.05	2056.10	2056.20
Ratio:	5:1	10:1	20:1
Reversal error [min]:	2.0	1.5	1.0
Efficiency:	0.40	0.30	0.20
Min. drive torque [Nm]:	0.06	0.06	0.06
Max. output torque [Nm]:	3.2	3.2	3.2
Max. revolutions [rev/s]*:	35	35	35
Weight [kg]:	0.6	0.6	0.6

## Flange size 83mm

	2083.05	2083.10	2083.20
Ratio:	5:1	10:1	20:1
Reversal error [min]:	2.0	1.5	1.0
Efficiency:	0.40	0.30	0.20
Min. drive torque [Nm]:	0,06	0,06	0,06
Max. output torque [Nm]:	3.2	3.2	3.2
Max. revolutions [rev/s]*:	35	35	35
Weight [kg]:	1.8	1.8	1.8

\* at input

## Versions

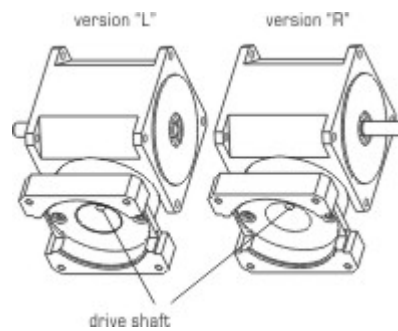

## Accessories

Flange extensions  
Heat-decoupled coupling

Included:  
Scale  
Coupling

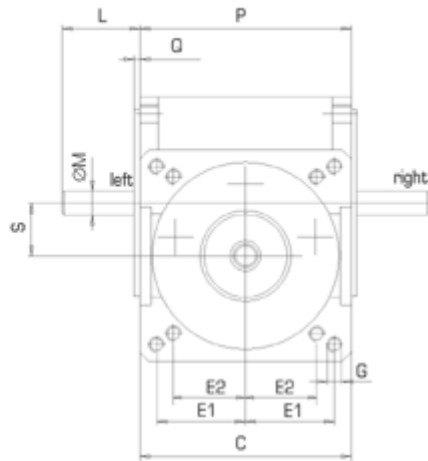
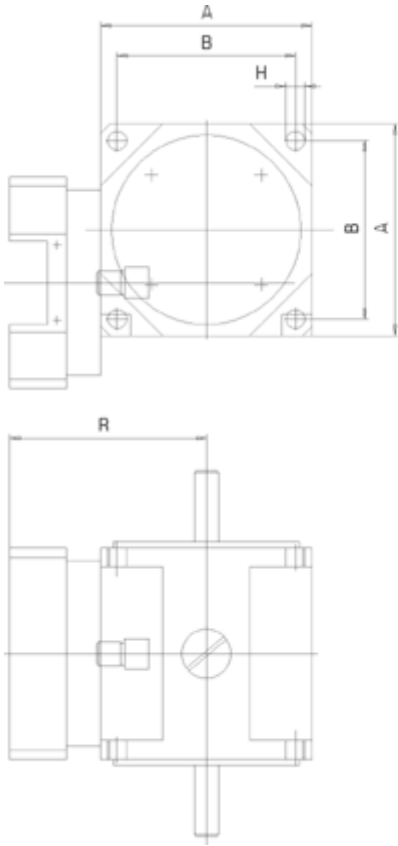

	A	B	C	E1	E2	G
2042.xx	42	36	42	18	15,5	M3
2056.xx	56	47,2	56	23,55	-	M4
2083.xx	83	69,6	83	34,8	-	M5
	H	L	M	P	G	R
2042.xx	3,5	16,5	5h7	42	1,5	39
2056.xx	5	20,5	6,35h7	56	1,5	52
2083.xx	5,6	30,5	9,52h7	83	1,5	77,5