

Goniometer Head 1003-MS

The Goniometer Head 1003-MS is driven by four step motors.

Limit switches can be optionally equipped to limit the operational range.

This unit is also available with other types of motors, there is a wide range of different versions. We would be happy to incorporate customer-specific alterations, if technically possible.

| | |
|------------------------|--------------|
| Adjustable axes: | X, Y, Ry, Rx |
| Range X [mm]: | +/- 11 |
| Range Y [mm]: | +/- 11 |
| Range Ry [°]: | +/- 18 |
| Range Rx [°]: | +/- 18 |
| Height [mm]: | 107 |
| Read-out accuracy [°]: | 0.1 |
| Weight [kg]: | 2.5 |
| Resolution X, Y [μm]: | 2.5 |
| Resolution Rx ["]: | 9 |
| Resolution Ry ["]: | 9 |

Further versions:

- vacuum suitable
- radiation resistant

Technical data motor:

| | |
|--------------------------|--------------|
| Type: | Vexta PK 223 |
| Number of phases: | 2 |
| Cable length [m]: | 0.5 |
| Connectors: | SUB D15 |
| Number of steps/rev: | 200/400 |
| Rated Current [A/Phase]: | 0.95 |
| Holding torque [Nm]: | 0.05 |
| Insulation class: | B |

Included:

- adjustment pin
- goniometer head key
- adhesive wax
- 2x sample carrier

Accessories:

| | |
|-----------------|----------|
| Support: | 1055 |
| | 1412 |
| Control system: | SMC 9300 |

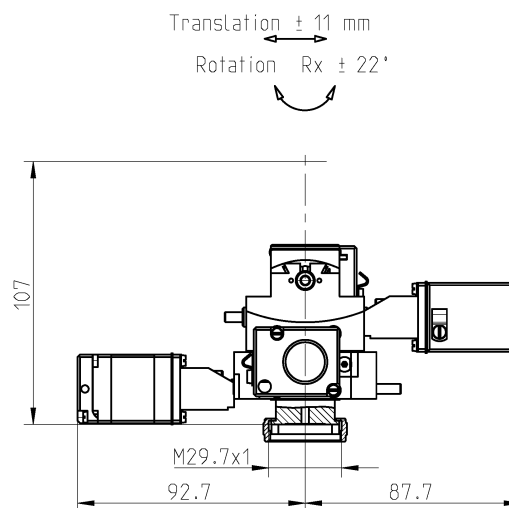
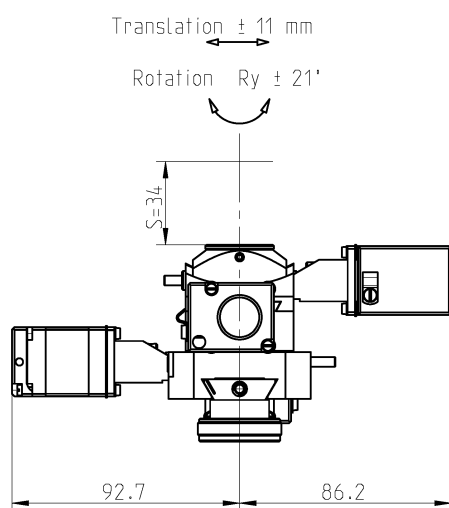

A-A

